

Drain: NEW BRITTON INDUSTRIAL PARK DRAIN **Drain #:** 226
Improvement/Arm: NEW BRITTON COMMERCIAL PARK - SECTION 3 RECONSTRUCTION
Operator: JDH **Date:** 8-16-04
Drain Classification: Urban/Rural **Year Installed:** 1997

GIS Drain Input Checklist

- Pull Source Documents for Scanning JDH
- Digitize & Attribute Tile Drains N/A
- Digitize & Attribute Storm Drains JDH
- Digitize & Attribute SSD N/A
- Digitize & Attribute Open Ditch N/A
- Stamp Plans JDH
- Sum drain lengths & Validate JDH
- Enter Improvements into Posse JDH
- Enter Drain Age into Posse _____
- Sum drain length for Watershed in Posse _____
- Check Database entries for errors JDH

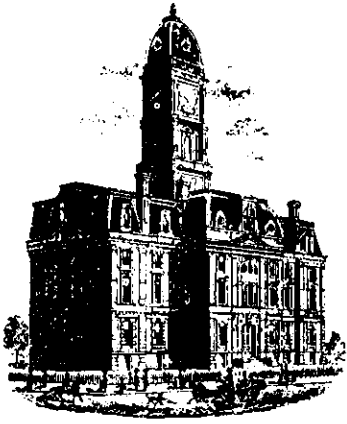

SURVEYOR'S OFFICE
Hamilton County

Kenton C. Ward, Surveyor

Phone (317) 776-8495

Fax (317) 776-9628

Suite 146

One Hamilton County Square

Noblesville, Indiana 46060-2230

January 30, 1997

TO: HAMILTON COUNTY DRAINAGE BOARD

RE: New Britton Industrial Park Drain #226

Attached is a petition, plans, non-enforcement request, and bonds for the relocation and reconstruction of the New Britton Industrial Park-Section 3. The petition has been filed by Garrick Mallery for a revision of the original drainage plan as set out in the report to the Board dated February 11, 1992.

The revision consists of the replacement of the original 320 feet of six (6") inch SSD with 211 feet of twelve (12") inch RCP. This is being done in order to move the original detention facility for Lots 11 and 12 to the East as shown on the attached plan by Schneider Engineering Corporation, dated October 25, 1996, Project NO. 15-96-020, sheet C101. The new pipe shall run East from the existing twelve (12") inch between Structures 101 and 104. Also to be included is the sixty (60') feet of eighteen (18") inch RCP between STR 113 and 114. The ten (10') feet between STR 113 and 104 is to be open ditch and is the only portion within the revised detention facility, which is regulated drain. The new plan reduces the length of drain by thirty-nine (39) feet.

The relocation is completely on the petitioners tract and is being paid for by the petitioner. Therefore, this item meets the requirements as set out in IC 36-9-27-52.5 which allows Board approval without notice for a public hearing.

The Petitioner has submitted a performance Bond for this Bond NO 58925588 dated December 16, 1996. The Petitioner should be given one (1) year from the date of approval to complete this

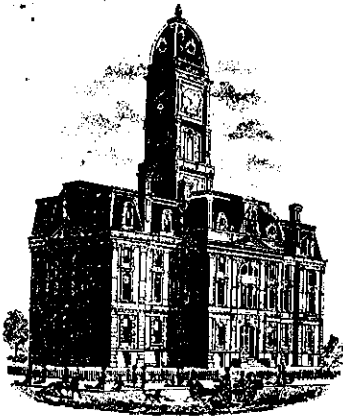

SURVEYOR'S OFFICE
Hamilton County

Kenton C. Ward, Surveyor

776-9626

942 Maple Avenue

Noblesville, Indiana 46060

February 11, 1992

5/18/92
9:15am

TO: Hamilton County Drainage Board

RE: New Britton Commercial Park Drain-Section 3 Arm

Attached is a petition, non-enforcement request, plans, calculations, quantity summary and assessment roll for the New Britton Commercial Park Drain.

I have reviewed the submittals and petition and have found each to be in proper form.

I have made a personal inspection of the land described in the petition. Upon doing so, I believe that the drain is practicable; will improve the public health; benefit a public highway and be of public utility; and that the costs, damages and expenses of land likely to be benefitted. The drain will consist of the following:

the proposed drain will probably be less than the benefits accruing to the owners of

6" SSD 320ft 12" RCP 272ft

The total length of the drain for this section will be 592 feet.

The subsurface drain (SSD) located in the detention area shall be part of the regulated drain. The detention area itself will not be considered a part of the regulated drain, but the Board shall be able to ensure any unauthorized structure or fill will not be

placed within it. This shall ensure the function and capacity of the facility shall ^{not} be hampered.

The twelve (12") inch RCP under the common drive for Lots 11 and 12, off 131st Street, shall not be considered as part of the regulated drain.

At this time I believe the existing sections of storm sewer should be assessed at this time. These sections serve 133rd Street and Britton Park Road. The length of these sections are as follows:

Twin 4x6 CMPA	90ft	15" RCP	188ft
15" CMP	80ft	18" RCP	637ft
12" RCP	474ft	24" RCP	32ft
Open Ditch	1450ft		

The total length of the existing sections is 2951 feet.

The open ditch included above extends from State Road 37 to 131st Street. The fifteen (15") inch CMP listed above is that under Britton Park Road at 131st Street. The total length of drain per this report shall be 3,543 feet.

I have reviewed the plans and believe the drain will benefit each lot equally. Therefore, I recommend each lot be assessed equally. I recommend a maintenance assessment of \$50.00 per lot, \$5.00 per acre for roadways, with a \$50.00 minimum. With this assessment the total annual assessment for the drain/this section will \$150.00.

These tracts may also be assessed to the Krause and Klepfer Drain at a future date.

I recommend the Board designate this drain as an Urban Drain and

that a hearing be set for May 1992. I also recommend the Board approve the attached non-enforcement of easement request at the time of hearing.

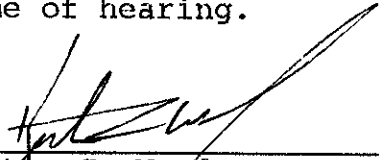

Kenton C. Ward
Hamilton County Surveyor

Hamilton County Drainage Board
Court House
Noblesville, Indiana

IN RE: McDonald's at 131st Street
Hamilton County, Indiana

PETITION FOR RELOCATION AND RECONSTRUCTION

Garrick Mallery (hereinafter "Petitioner"),
hereby petitions the Hamilton County Drainage Board for authority to re-
locate and improve a section of the Section 3 Arm of the
New Britton Commercial Park Drain,
and in support of said petition advises the Board that:

1. Petitioner owns real estate through which a portion of the
Section 3 Arm of the
New Britton Commercial Park Drain runs.
2. Petitioner plans to develop its real estate with roads, buildings,
utilities, storm drains, sanitary sewers and other structures.
3. Petitioner's proposed development of its real estate will require
relocation and reconstruction of a portion of the Section 3 Arm of the
New Britton Commercial Park Drain, as specifically shown on engineering plans and specifications
filed with the Hamilton County Surveyor.
4. The work necessary for the proposed relocation and reconstruction
will be undertaken at the sole expense of the Petitioner and such
work will result in substantial improvement to the Section 3 Arm of the
New Britton Commercial Park Drain, without cost to other property owners on the watershed of
the Section 3 Arm of the
New Britton Commercial Park Drain.

WHEREFORE, Petitioner requests that an Order issue from the Hamilton
County Drainage Board authorizing relocation and reconstruction of the
Section 3 Arm of the
New Britton Commercial Park Drain, in conformance with applicable
law and plans and specifications on file with the Hamilton County Surveyor.

Garrick Mallery
Signed

Garrick Mallery
Printed Name

FILED

DEC 11 1996

OFFICE OF HAMILTON COUNTY SURVEYOR



Bond No: 5892588

SUBDIVISION IMPROVEMENT BOND

KNOW ALL MEN BY THESE PRESENTS, THAT:

MCDONALD'S CORPORATION, as Principal, and
SAFECO INSURANCE COMPANY OF AMERICA, as Surety, are
held and firmly bound unto HAMILTON COUNTY

_____, as Oblige, in the amount of
Six Thousand Seven Hundred and 00/100 Dollars, (\$6,700.00)
for payment whereof said Principal and Surety bind themselves, their heirs, executors,
administrators, successors and assigns, jointly and severally, firmly by these presents.

THE CONDITION OF THIS OBLIGATION is such that if said Principal shall construct in
accordance with the preliminary plat thereof, the following improvements to wit: _____
storm sewer - northwest corner of East 131st Street and State Road 37, Fishers, Indiana

in accordance with the applicable regulations, specifications, standards, ordinances and laws of
said HAMILTON COUNTY
and of the State of INDIANA, then this obligation to be void;
otherwise to remain in full force and effect.

The Surety hereby waives notice of any alteration or extension of time made by Oblige.

Dated at Chicago, Illinois this 16th day of December 19 96.

MCDONALD'S CORPORATION

By: _____

JERRY R. LANE

SAFECO INSURANCE COMPANY OF AMERICA

Surety

By: _____

Therese E. Rowedder

Attorney-in-Fact





POWER OF ATTORNEY



SAFECO INSURANCE COMPANY OF AMERICA
GENERAL INSURANCE COMPANY OF AMERICA
HOME OFFICE: SAFECO PLAZA
SEATTLE, WASHINGTON 98185

No. 7591

KNOW ALL BY THESE PRESENTS:

That SAFECO INSURANCE COMPANY OF AMERICA and GENERAL INSURANCE COMPANY OF AMERICA, each a Washington corporation, does each hereby appoint
**ELLEN, L. COPE; PATRICIA THURMOND; JENNIFER L.B ROWN; GARRY L. WESSELINK; GEOFFREY E. HEKIN;
BRENDA D. HOCKBERGER; ANN FORMHALS; DONNA WRIGHT; ROBERT E. DUNCAN; DEBRA KOHLMAN; THERESAN E.
ROWEDDER; CHRISTINE ZARETSKY; JULIE ZUNIGA; KRISTAN CLARK; Chicago, Illinois*****

its true and lawful attorney(s)-in-fact, with full authority to execute on its behalf fidelity and surety bonds or undertakings and other documents of a similar character issued in the course of its business, and to bind the respective company thereby.

IN WITNESS WHEREOF, SAFECO INSURANCE COMPANY OF AMERICA and GENERAL INSURANCE COMPANY OF AMERICA have each executed and attested these presents

this 16th day of April, 19 96

CERTIFICATE

Extract from the By-Laws of SAFECO INSURANCE COMPANY OF AMERICA
and of GENERAL INSURANCE COMPANY OF AMERICA:

"Article V, Section 13. - FIDELITY AND SURETY BONDS . . . the President, any Vice President, the Secretary, and any Assistant Vice President appointed for that purpose by the officer in charge of surety operations, shall each have authority to appoint individuals as attorneys-in-fact or under other appropriate titles with authority to execute on behalf of the company fidelity and surety bonds and other documents of similar character issued by the company in the course of its business . . . On any instrument making or evidencing such appointment, the signatures may be affixed by facsimile. On any instrument conferring such authority or on any bond or undertaking of the company, the seal, or a facsimile thereof, may be impressed or affixed or in any other manner reproduced; provided, however, that the seal shall not be necessary to the validity of any such instrument or undertaking."

Extract from a Resolution of the Board of Directors of SAFECO INSURANCE COMPANY OF AMERICA
and of GENERAL INSURANCE COMPANY OF AMERICA adopted July 28, 1970.

"On any certificate executed by the Secretary or an assistant secretary of the Company setting out,

- (i) The provisions of Article V, Section 13 of the By-Laws, and
- (ii) A copy of the power-of-attorney appointment, executed pursuant thereto, and
- (iii) Certifying that said power-of-attorney appointment is in full force and effect.

the signature of the certifying officer may be by facsimile, and the seal of the Company may be a facsimile thereof."

I, R. A. Pierson, Secretary of SAFECO INSURANCE COMPANY OF AMERICA and of GENERAL INSURANCE COMPANY OF AMERICA, do hereby certify that the foregoing extracts of the By-Laws and of a Resolution of the Board of Directors of these corporations, and of a Power of Attorney issued pursuant thereto, are true and correct, and that both the By-Laws, the Resolution and the Power of Attorney are still in full force and effect.

IN WITNESS WHEREOF, I have hereunto set my hand and affixed the facsimile seal of said corporation

this 16th day of December, 19 96



S-974/EP 1/93

® Registered trademark of SAFECO Corporation.

State of Illinois
County of Cook



On this 16th day of December, 19 96, before me personally appeared Theresan E. Rowedder, known to me to be the Attorney-in-fact of Safeco Insurance Company of America, the corporation that executed the within instrument, and acknowledged to me that such corporation executed the same.

IN WITNESS WHEREOF, I have hereunto set my hand and affixed my official seal, at my office in the aforesaid county, the day and year in the certificate first above written.

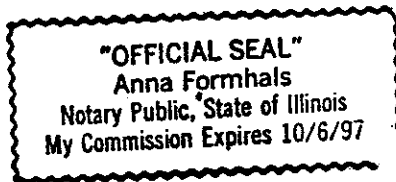

Anna Formhals
(Notary Public)

CERTIFICATE OF COMPLETION AND COMPLIANCE

TO: HAMILTON COUNTY SURVEYOR

RE: Relocation and reconstruction of the New Britton Industrial Park Section 3 drain.
Amoco and McDonald's site at 131st and State Road 37.

I hereby certify that:

- 1.) I am a Registered Engineer in the State of Indiana,
- 2.) I am familiar with the plans and specifications for the above referenced subdivision,
- 3.) I have personally observed and supervised the completion of the Drainage Facilities for the above referenced subdivision, and
- 4.) To the best of my knowledge, information and belief, the Drainage Facilities within the subdivision has been installed and completed in conformity with all plans and specifications, except as noted below.

Signature: _____ Date: _____

Type or Printed Name: Patrick J. Gallagher

Business Address: Schneider Engineering Corporation

3020 North Post Road, Indianapolis, IN 46226-6518

Telephone: (317) 898-8282

INDIANA REGISTRATION NUMBER

9300469

SEAL



Exception (s)

- 1. The proposed wet pond was constructed as a dry basin due to concerns for public safety. The change has no significant impact on the Functionality of the drainage system.

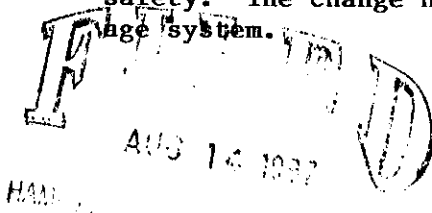



SURVEYOR'S OFFICE

Hamilton County

Kenton C. Ward, Surveyor

Phone (317) 776-8495

Fax (317) 776-9628

Suite 146

One Hamilton County Square

Noblesville, Indiana 46060-2230

To: Hamilton County Drainage Board

August 26, 1997

**Re: New Britton Industrial Park -
New Britton Commercial Park Sec. 3
Reconstruction**

Attached are as-builts, certificate of completion & compliance, and other information for New Britton Commercial Park Sec. 3 Reconstruction. An inspection of the drainage facilities for this section has been made and the facilities were found to be complete and acceptable.

During construction, changes were made to the drain which will alter the plans submitted with my report for this drain dated January 20, 1997. The changes are as follows:

Str.101-104 12"RCP lengthened from 211' feet to 217' feet.

Str.113-114 12"RCP lengthened from 60' feet to 61' feet.

The 320' feet of 6"SSD that was to be installed with section 3 was never installed. Thus, the 12"RCP installed with this reconstruction is additional footage added to the total length of drain for New Britton Commercial Park Sec. 3.

The net length of the drain due to the changes described above is now **278 feet**.

The non-enforcement was approved by the Board at its meeting on February 10, 1997 and recorded under instrument #9709705064.

The bond or letter of credit from Safeco Insurance company, number 58925588; dated December 16, 1996; in the amount of \$6,700.00; has as of yet not been released by the Commissioners.

I recommend the Board approve the drains construction as complete and acceptable.

Sincerely,

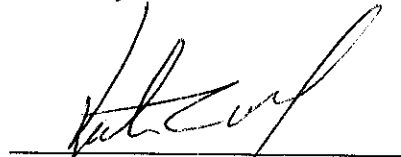

Kenton C. Ward,
Hamilton County Surveyor

KCW/slm

Asbuilt Structures

Project: New Britton Industrial Park - McDonalds/Hanaco Relocation

Structure: T.C.: I.E.: Pipe: Length: Original Plans: Difference:

Str. 102	-	801.19			
Str. 101	804.63	800.90	12"	29'	From 20'
Str. 101	804.63	800.78			
Str. 104	-	802.64	12"	217'	From 211'
Str. 113	-	802.90			
Str. 114	805.55	803.25	18"	61'	From 60'

6" SSD Streets:

Total: _____

RCP Pipe Totals:

6" SSD Lots:

Total: _____

Other Drain:

Total Length of Drain: _____

This information was entered for input into the Hamilton County Survey Information System. This information is considered an acknowledgment of the data.

Entry Date: 8/16/97
Entered by: JWH

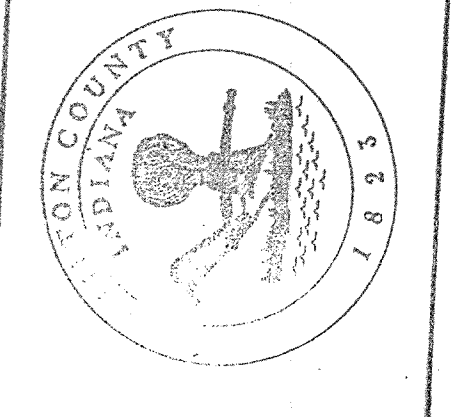
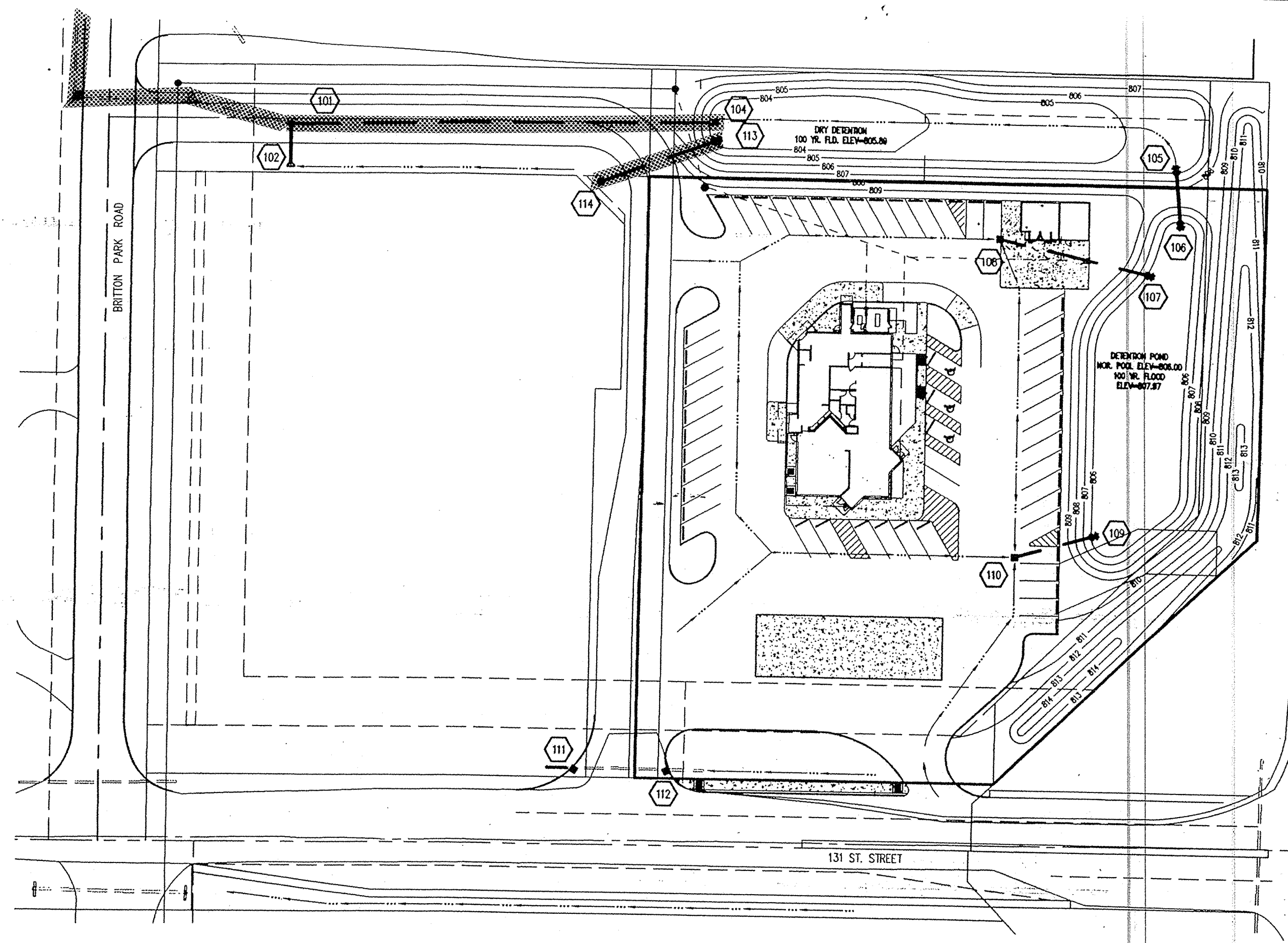
HOLEY MOLEY SAYS
"DON'T DIG BLIND"
CALL TOLL FREE
1-800-382-5544
1-800-428-5200
FOR CALLS OUTSIDE OF INDIANA
PER INDIANA STATE LAW IS-69-1991, IT IS AGAINST THE LAW TO EXCAVATE WITHOUT NOTIFYING THE UNDERGROUND LOCATION SERVICE TWO (2) WORKING DAYS BEFORE COMMENCING WORK.

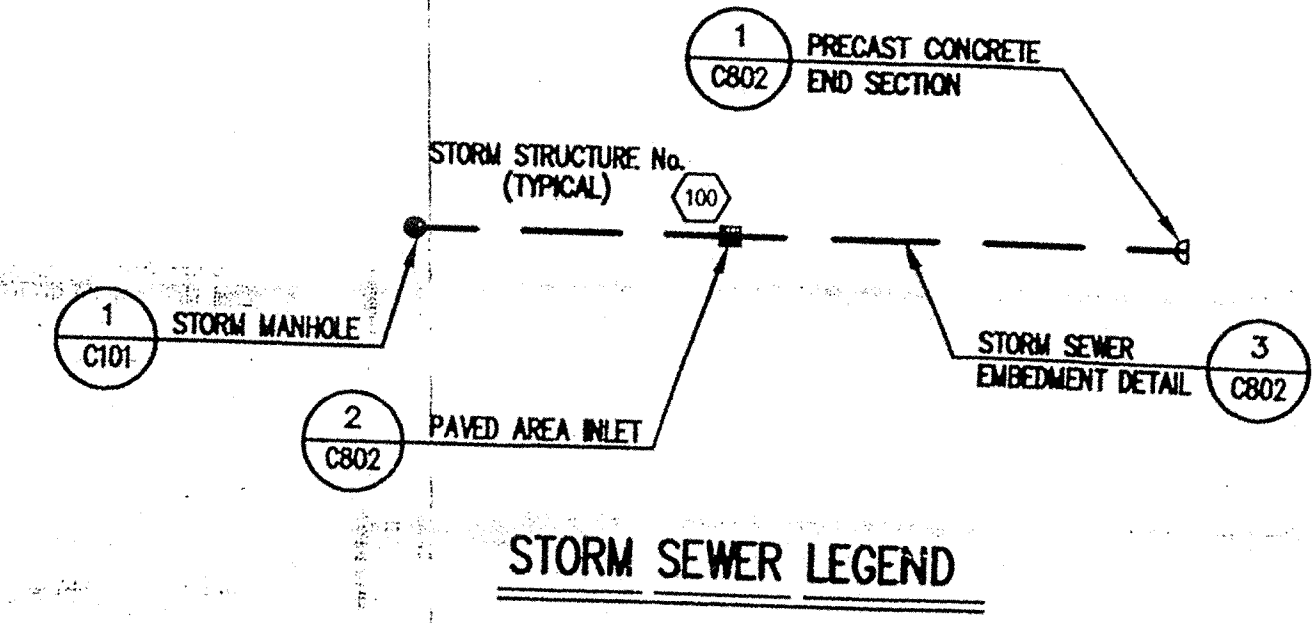

GENERAL NOTES

- TEMPORARY TRAFFIC CONTROL DURING CONSTRUCTION TO CONFORM TO APPLICABLE LOCAL AND STATE STANDARDS.
- ALL CONSTRUCTION ACTIVITY ON THIS SITE TO BE PERFORMED IN COMPLIANCE WITH APPLICABLE O.S.H.A. STANDARDS FOR WORKER SAFETY.
- IT SHALL BE THE CONTRACTORS RESPONSIBILITY TO FIELD VERIFY ALL UTILITY LOCATIONS BEFORE CONSTRUCTION BEGINS.
- CONTRACTORS SHALL MINIMIZE DAMAGE TO EXISTING TREES.

BENCHMARK

Indiana State Highway Commission HAM 0-64
A bronze plate on the top of the concrete coping of a culvert over an open ditch about 1030 feet north of the centerline of 131st Street and about 35 feet east of the centerline of the pavement of the north bound lanes of State Road 37.
Elevation = 806.89 (NGVD 1929)

TBM 1
A cut square in a concrete head wall at the southwest corner of 131st Street and Britton Park Drive.
Elevation = 810.25

TBM 2
A railroad spike 1 foot up in the south side of utility pole No. 191-54E on the south side of 131st Street and being the first utility pole west of State Road 37.
Elevation = 814.09

- Revisions
- PRC 1/06/97 - LARGER STR. Nos. CHANGED PIPE TYPE BETWEEN STRs 105 & 106, 107 & 108, REMOVED RIP-RAP @ STR 102 IN PROFILE & ADJUSTED EAST ENTRANCE ALONG 131 ST. STREET.
 - TJ 8/11/97 STORM SEWER RECORD DRAWING.

STORM SEWER PLAN

SCALE: 1"=50'

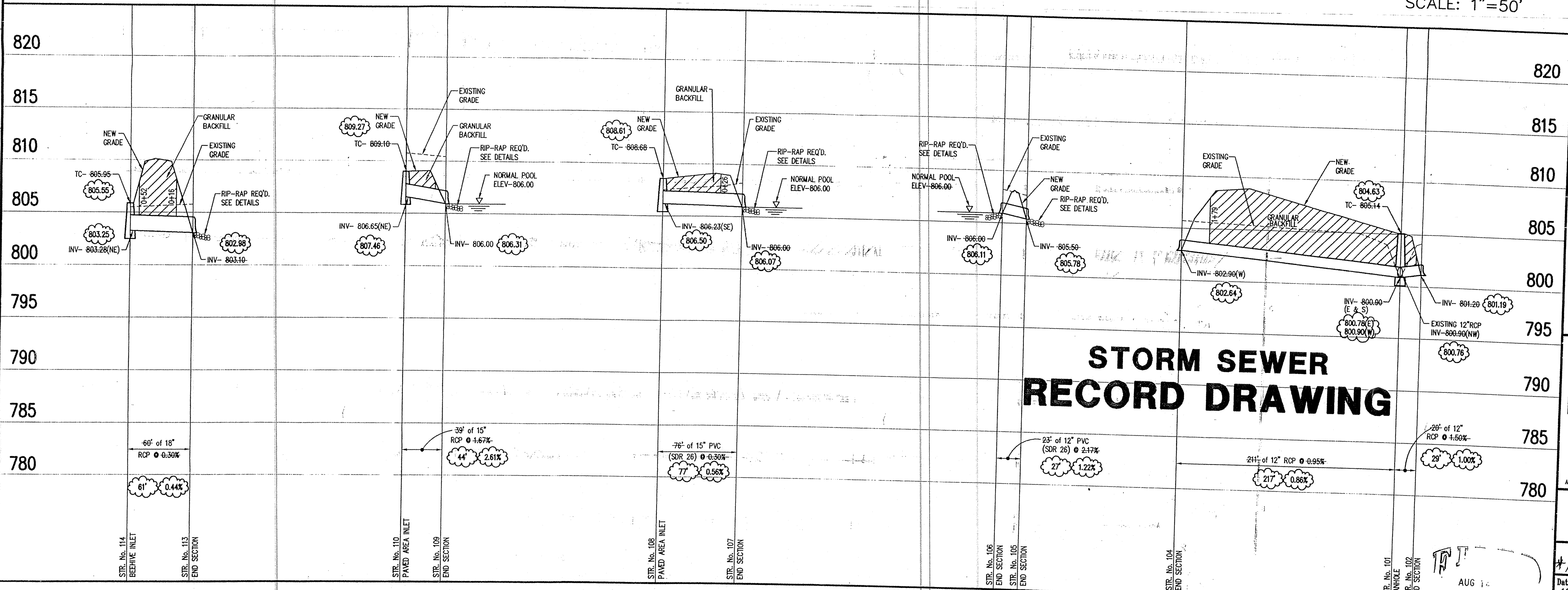

STORM SEWER PROFILE

SCALE: HORIZ.: 1"=50'
VERT.: 1"=5'

CERTIFICATION FOR "RECORD DRAWING"

NOTE:
Record drawing certification only for top of casting, invert elevations and lengths of pipe. Slope percentage represents a calculated figure and is for general information only.

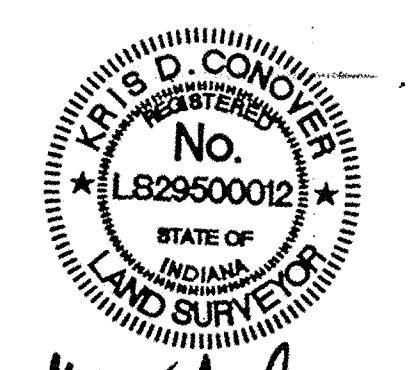

CERTIFIED BY: *Kristin D. Conover*

THIS DRAWING AND THE IDEAS, DESIGNS AND CONCEPTS CONTAINED HEREIN ARE THE EXCLUSIVE INTELLECTUAL PROPERTY OF SCHNEIDER ENGINEERING CORPORATION AND ARE NOT TO BE USED OR REPRODUCED IN WHOLE OR IN PART, WITHOUT THE WRITTEN CONSENT OF SCHNEIDER ENGINEERING CORPORATION.

© 1996, Schneider Engineering Corporation

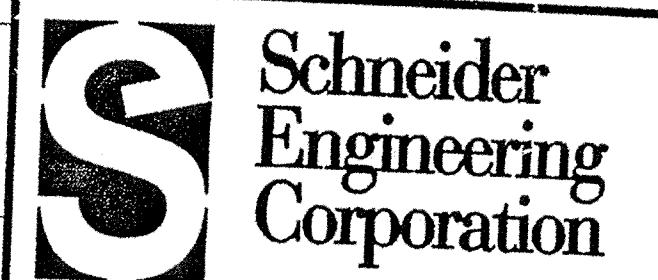

3020 North Post Road
Indianapolis, Indiana 46226-0068
317-898-8282
317-899-8010 Fax

Engineering
Surveying
Landscape Architecture
GIS • LIS
Geology

A Partnered Entity with Bohlen, Meyer, Gibson & Associates, Incorporated

McDONALD'S CORPORATION
McDONALD'S, 131st STREET & S.R. 37
FISHERS, INDIANA

STORM SEWER PLANS
New Britton Com. Park Sec. 3 Reconstruction

Date	Project No.	Drawn	Approv.
12/20/96	15-96-020	DMW	

Computer Files
15-96-020\WCS\020\0601
XREF: 02085
XREF: 2051E
XREF: 1596020
XREF: STORM

Sheet No.
C601

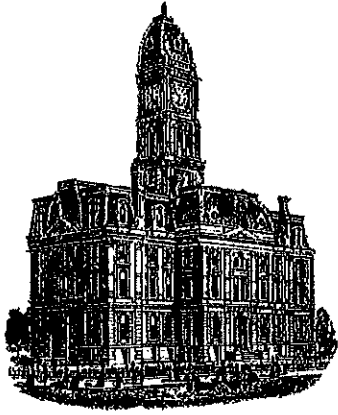

Kenton C. Ward, CFM
Surveyor of Hamilton County
Phone (317) 776-8495
Fax (317) 776-9628

Suite 188
One Hamilton County Square
Noblesville, Indiana 46060-2230

Map Correction-Field Verification

Drain Number: 226

Drain Length: 278

Drain Name: New Britton Ind. Park
(Sec 3 Reconstruction- 1997)

Change + / - : 10

Date: 08-04-2020

New Length: 288

Verified By: SLM, JLL

Notes & Sketch:

The open ditch between Structures 113 to 104 was missed in the final report for this section of drain. The inspection report dated July 16, 1997 calls out this section of drain. It is also called out to be regulated in the revised Surveyor's report to the Drainage Board dated January 30, 1997. Therefore, this open ditch should be included on the regulated drain map and regulated drain inventory.

Suzanne L. Mills
GIS Specialist

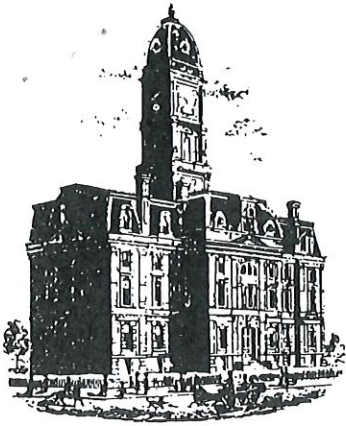

SURVEYOR'S OFFICE
Hamilton County

Kenton C. Ward, Surveyor

Phone (317) 776-8495

Fax (317) 776-9628

Suite 146

One Hamilton County Square

Noblesville, Indiana 46060-2230

July 16, 1997

To: Mr. Steve Hartley
Hartley Excavating

Re: New Britton Industrial Park Drain

The Hamilton County Surveyors Office conducted an inspection of the relocation and reconstruction of the New Britton Industrial Park Sec. 3 Drain across the new Amoco and McDonalds site at 131st and State Road 37 on July 15, 1997.

The following punchlist items will need to be addressed before the reconstruction is accepted.

- ✓ 1. **Structure 114** Clean out Structure (sediment). Grout under riser ring (corners of structure).
- ✓ 2. **Structure 113** Clean off concrete end section.
- ✓ 3. Define a channel between end sections (Structures 113 and 104). This channel is part of the regulated drain reconstruction and is mentioned in the county surveyor's report to the board.
- ✓ 4. Flush 18" storm pipe between structures 114 and 113. Remove accumulation of sediment from pipe.
- ✓ 5. **Structure 104** Clean off concrete end section. Install trash guard on end section per detail on sheet C103.
- ✓ 6. **Structure 101** Realign and grout casting. Grout under flat top.
- ✓ 7. **Structure 102** Beef up erosion control in front of end section to prevent sediment from entering storm sewer system.
- ✓ 8. **Existing structure west of structure 101.** Structure was lowered to new grade. Grout riser rings and under flat top in structure. Realign and grout casting (casting has been hit and moved by construction equipment).
9. The engineer will need to submit record drawings to the Surveyor's Office for the relocation and reconstruction of the New Britton Industrial Park Sec. 3 Drain.

REINSP. 15 MIN.

New Britton Drain (cont.)
Page 2

I will need to reinspect these items within twenty (20) days of you recieving my letter. Please prepare these items for reinspection.
If you have any questions I can be reached at 776-8495.

Sincerely,

A handwritten signature in cursive script, appearing to read "Andrew D. Conover", written over a horizontal line.

Andrew D. Conover
Inspector

cc: Commissioners
Jim Brimbury
Fishers Planning
Schneider Engineering

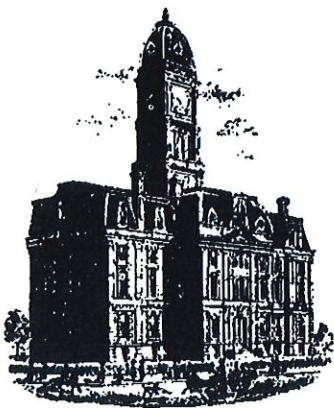

SURVEYOR'S OFFICE
Hamilton County

Kenton C. Ward, Surveyor

Phone (317) 776-8495

Fax (317) 776-9628

Suite 146

One Hamilton County Square

Noblesville, Indiana 46060-2230

January 30, 1997

TO: HAMILTON COUNTY DRAINAGE BOARD

RE: New Britton Industrial Park Drain #226

Attached is a petition, plans, non-enforcement request, and bonds for the relocation and reconstruction of the New Britton Industrial Park-Section 3. The petition has been filed by Garrick Mallery for a revision of the original drainage plan as set out in the report to the Board dated February 11, 1992.

The revision consists of the replacement of the original 320 feet of six (6") inch SSD with 211 feet of twelve (12") inch RCP. This is being done in order to move the original detention facility for Lots 11 and 12 to the East as shown on the attached plan by Schneider Engineering Corporation, dated October 25, 1996, Project NO. 15-96-020, sheet C101. The new pipe shall run East from the existing twelve (12") inch between Structures 101 and 104. Also to be included is the sixty (60') feet of eighteen (18") inch RCP between STR 113 and 114. The ten (10') feet between STR 113 and 104 is to be open ditch and is the only portion within the revised detention facility, which is regulated drain. The new plan reduces the length of drain by thirty-nine (39) feet.

The relocation is completely on the petitioners tract and is being paid for by the petitioner. Therefore, this item meets the requirements as set out in IC 36-9-27-52.5 which allows Board approval without notice for a public hearing.

The Petitioner has submitted a performance Bond for this Bond NO 58925588 dated December 16, 1996. The Petitioner should be given one (1) year from the date of approval to complete this



Missing open ditch

BRITTON PARK RD

131st ST

S.R. 37



This map was compiled by the Hamilton County Surveyor's Office. Although strict accuracy standards have been employed in the compilation of this map, Hamilton County does not warrant or guarantee the accuracy of the information contained herein and disclaims any and all liability resulting from any error or omission in this map.

New Britton Ind. Park #226

Printing Date: 07/22/2020
Prepared By: Suzanne Mills, GISP
Hamilton County Surveyor's Office
One Hamilton County Square, Ste 188
Noblesville, IN 46060
317-776-8495

